

Breville®

Turn **on** your creativity®



Turbo Charge Corded / Cordless Iron

VIN439

Important Safety Information

READ CAREFULLY AND KEEP FOR FUTURE REFERENCE

This appliance can be used by children aged 8 years and above and by persons with reduced physical, sensory or mental capabilities or lack of experience and knowledge if they have been given supervision or instruction concerning use of the appliance in a safe way and understand the hazards involved. Children shall not play with the appliance. Cleaning and user maintenance shall not be made by children without supervision.

Keep the appliance and its cord out of the reach of children less than 8 years old when it is switched on or cooling down.

Never use this appliance for anything other than its intended use. This appliance is for household use only. Do not use this appliance outdoors.

If the supply cord is damaged, it must be replaced by the manufacturer, its service agent or similarly qualified persons in order to avoid a hazard.

The appliance must not be left unattended when it is connected to the mains supply.

The appliance must be unplugged from the mains supply socket before filling the water tank with water.

Always use the appliance on a stable, secure, dry and level surface. When placing the appliance on its stand, ensure that the surface on which the stand is placed is stable.

Do not use the appliance if it has been dropped, if there are any visible signs of damage or if it is leaking.

THE IRON MUST ONLY BE USED WITH THE STAND PROVIDED.

- ⚠ Always ensure that hands are dry before handling the plug or switching on the appliance.
- ⚠ Do not touch the metal parts of the appliance during use as they may become very hot.
- ⚠ This appliance must not be placed on or near any potentially hot surfaces (such as a gas or electric hob).
- ⚠ Always allow the appliance to cool before cleaning or storing.
- ⚠ Never immerse any part of the appliance, charging base or power cord and plug in water or any other liquid.
- ⚠ Never let the power cord hang over the edge of a worktop, touch hot surfaces or become knotted, trapped or pinched.
- ⚠ Use only with the charging base provided. Do not set the iron on an unprotected surface, even if it is on the charging base.
- ⚠ Lock the iron onto the charging base in the vertical position when not in use.

⚠ The steam control should always be turned to the dry  setting before plugging or unplugging from outlet.

Parts

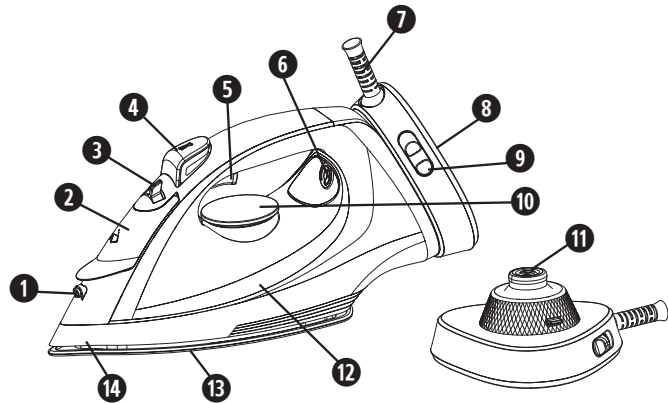

- | | |
|--------------------------------------|--------------------------------------|
| 1. Spray Nozzle | 8. Charging Base |
| 2. Water Tank Inlet Cover | 9. Lock/Unlock Base Switch |
| 3. Steam Control / Self Clean Lever | 10. Temperature Control Dial |
| 4. Spray Mist Button | 11. Charging Base Inlet Switch |
| 5. Shot of Steam Button | 12. Water Tank |
| 6. Temperature Ready Indicator Light | 13. Soleplate |
| 7. Swivel / Cord Strain | 14. SAFE-STORE™ Heat Indicator Strip |

Before using for the first time

⚠ **Warning:** Remove all packaging including any soleplate protection before using your iron.

Before connecting your iron to the mains supply, make sure your supply voltage is the same as the one indicated on your iron.

When you first use your iron, there may be a slight odour and it may smoke slightly for the first few minutes of operation. This is quite normal and will disappear.

Cleaning your iron before use

Follow these simple steps to remove any impurities or residues inside your steam iron that may be left over from the manufacturing process.

1. Follow the instructions under filling your iron and fill the water tank as described.
2. Empty the water tank to rinse out any foreign particles then refill it.
3. Follow the instructions under steam ironing. Set the temperature to the MAX setting and the steam control to the high steam setting.
4. Iron an old piece of cloth (cotton or towels are ideal) for a few minutes. While ironing, press the steam button 4 or 5 times.
5. Any impurities will be flushed from your iron by the steam and absorbed by the cloth. Your iron is now ready for use.

Filling your iron

1. Ensure your iron is switched off and unplugged from the mains supply socket.
2. Set the steam control (3) to the no steam position ☼.
3. Open the water tank inlet cover.
4. Using a jug, fill the water tank with ordinary tap water. To avoid air locks, tilt your iron slightly while filling it.
5. Don't fill the iron above the water level indicator MAX marking. Check the water level by standing the iron on its heel.
6. When the iron is filled, ensure the water tank inlet cover is fully closed and sealed to prevent water leaking out when the iron is in use.

Ironing in corded mode 🔒

1. Dock the iron in the vertical position onto the charging base (8).
2. Move the lock/unlock base switch to the locked position 🔒.
3. To ensure the iron is locked into place, rotate the iron on the charging base until an audible clicking sound is heard and the heel is aligned with the base.
4. Lift the iron by the handle to ensure that it is securely locked onto the base (Figure 1).
5. Keep the iron on the heel rest of the charging base when not ironing.

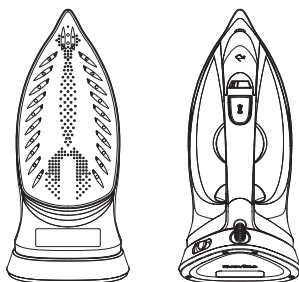

Figure 1

Ironing in cordless mode 🔒

1. Dock the iron in the vertical position onto the charging base (8).
2. When the iron is charging, the temperature indicator light (6) will illuminate red. For first use, wait until the temperature indicator light illuminates green; then the iron is ready for use.
3. Unlock the iron from the charging base (8) by moving the lock/unlock base switch (9) to the unlocked position 🔓.
4. Hold the iron by the handle and remove from the base (Figure 2). The temperature indicator light (6) will turn off when undocked.
5. Start ironing.
6. Return the iron onto the charging base every few seconds to re-heat the soleplate.
7. The temperature indicator light (6) will illuminate red to indicate the iron is reheating and turn green when ready to use.

IMPORTANT: When using the shot of steam feature, your iron might cool down faster; therefore, it might take additional time to reheat.

NOTE: The Turbo Charge Corded Cordless Iron is NOT a rechargeable device with a battery. You cannot continuously use this iron without placing it on the charging base to reheat the soleplate.

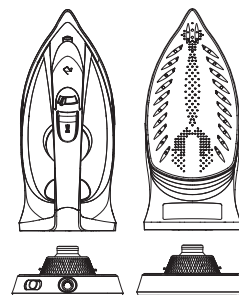

Figure 2

Ironing without steam

If you intend to dry-iron fabrics there is no need to fill the water tank. However, if water is already in the water tank, you don't need to empty it.

1. Set the steam control (3) to the no steam position ☼.
2. With your iron locked onto the charging base (8), plug your iron into the mains supply and switch on.
3. Rotate the temperature control dial (10) until the desired setting is aligned with the dial pointer.
4. When the iron is charging, the temperature indicator light (6) will illuminate red. When the light turns to green, your iron is ready to use.
5. Unlock the iron from the charging base (8) by moving the lock/unlock base switch (9) to the unlocked position 🔓.
6. Hold the iron by the handle and remove from the base (Figure 2). The temperature indicator light (6) will turn off when undocked.
7. Start ironing.
8. Return the iron onto the charging base every few seconds to re-heat the soleplate.
9. The temperature indicator light (6) will illuminate red to indicate the iron is reheating and turn green when ready to use.
10. Alternatively, move the lock/unlock base switch to the locked position 🔒 to use the iron in corded mode.

Steam ironing

During steam ironing, if you do not allow your iron to reach the selected temperature water may drip from the soleplate.

It is recommended that for harder to iron fabrics such as cotton and linen, steam should be used when ironing.

When ironing cotton and linen, always select the highest temperature. **Steam should never be used on delicate fabrics like nylons, acrylics and synthetics.**

1. Fill your iron with water. The water reservoir must be at least ¼ full of water.
2. With your iron locked onto the charging base (8), plug your iron into the mains supply and switch on.
3. Set the temperature control dial (10) to the ** or *** setting. The hotter your iron, the more steam is generated.
4. When the iron is charging, the temperature indicator light (6) will illuminate red. When the light turns to green, your iron is ready to use.

- Adjust the steam control (3) to select the desired steam output. To use the max steam setting, push and hold the steam control towards the setting (Figure 3).
- The steam can be shut off at any time by setting the steam control to the no steam position.
- Unlock the iron from the charging base (8) by moving the lock/unlock base switch (9) to the unlocked position.
- Hold the iron by the handle and remove from the base (Figure 2). The temperature indicator light (6) will turn off when undocked.
- Start ironing.
- Return the iron onto the charging base every few seconds to re-heat the soleplate.
- The temperature indicator light (6) will illuminate red to indicate the iron is reheating and turn green when ready to use.
- Alternatively, move the lock/unlock base switch to the locked position to use the iron in corded mode.

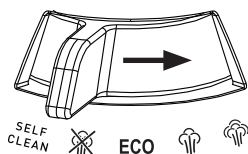

Figure 3

Note: Dripping from the soleplate may occur if the max steam setting is used continuously in cordless mode. The iron will need to be returned to the charging base more frequently to re-heat.

Shot of steam

- The temperature control dial (10) must be set within the ** and *** setting.
- The water reservoir must be at least ¼ full of water.
- Press the shot of steam button (5) whenever you have a stubborn crease that needs extra steam. Steam will burst from the holes in the soleplate of your iron into the fabric.
- The shot of steam button may be used continuously in approximately 3-second intervals. Dripping from the soleplate may occur when the shot of steam button is pressed too frequently. If ironing in cordless mode, return the iron to the charging base every few seconds to reheat.

Vertical steam ironing

Never iron garments when they are being worn.

- Prepare your iron as for steam ironing.
- Hold your iron 15cm from the fabric.
- Press the shot of steam button (5) as required. Wait several seconds between each press of the button.
- If ironing in cordless mode, return the iron to the charging base every few seconds to reheat.

Spray Mist

The water spray can be used to help iron heavy fabrics or difficult areas (collars, pockets, sleeves, creases, etc). It can also be used when ironing delicate fabrics which cannot be steam ironed.

Make sure there is water in the tank. Press the spray mist button (4) to produce a spray of water.

Anti-drip feature

When the temperature of your iron is insufficient to create steam, the supply of water is cut off automatically to avoid any drips from the soleplate.

Anti-scale filter

Your iron is fitted with a permanent anti-scale filter. This filter is fixed and cannot be removed for cleaning.

The filter is designed to reduce the build-up of limescale inside your iron. Limescale occurs during steam ironing due to water hardness.

Water hardness varies from one area to another. The effectiveness of the filter will depend on how 'hard' your water is.

Auto shut off feature

ALWAYS disconnect your iron from the mains supply socket after use. **NEVER** leave the iron unattended with the auto shut off function in operation.

An electronic safety device will automatically switch the heating element off if the iron has not been moved more than 30 seconds when resting on its soleplate in a horizontal position.

If resting on its heel in a vertical position, this will happen after 15 minutes.

The temperature ready indicator will blink red when auto-off is activated. Note: The temperature ready indicator will blink only if the iron is docked onto the charging base.

To restart your iron, gently move it until the light stops flashing and reheats until the temperature ready indicator illuminates green.

Care and cleaning

Warning: Do not use harsh abrasives, chemical cleaners or solvents to clean the exterior of your iron and charging base.

Allow your iron to completely cool down and wipe the soleplate with a soft damp cloth. If polyester has burnt to the soleplate, iron a damp cotton cloth while your iron is still hot. Wipe over the rest of your iron with a soft damp cloth then wipe dry.

Do not immerse the appliance, charging base or power cord or plug in water or any other liquid.

Self-cleaning

Only press the self-clean lever (3) when you want to activate the self-cleaning system. Never press the self-clean lever when ironing.

The self-clean function removes scale and impurities. Use the self-clean function once every two weeks. If the water in your area is very hard, the self-clean function should be used more frequently.

- Ensure your iron is switched off and unplugged from the mains supply socket.
- Set the steam control (3) to the no steam position.
- Fill your iron with water to the MAX level.
- Dock the iron in the vertical position onto the charging base (8).
- Move the lock/unlock base switch to the locked position. Do not release the iron from the charging base during the cleaning process.
- Plug in and switch on at the mains supply.
- Set the temperature control dial (10) to the highest (MAX) setting. Allow your iron to heat up until the temperature indicator light illuminates green.
- Unplug your iron from the mains and hold it over a sink with the soleplate facing downwards.
 - Warning:** Be careful not to touch the iron's hot surfaces.
- Push and hold the steam control lever (3) to the self-clean position. Hot water and steam will be ejected from the holes in the soleplate along with any impurities.
- Slowly rock the iron side-to-side and front to back for 30 seconds. When rocking the iron, dip the nose of the iron slightly below the rear to make certain the water circulates completely.
- Release the self-clean lever (3) after 30 seconds and pour out the remaining water out of the fill hole.
- Rest the iron soleplate horizontally on an old piece of cloth (cotton or towels are ideal) to dry.
- Plug in the iron and turn the temperature control dial to the *** setting.
- When the temperature indicator light illuminates green, iron an old piece of cloth to allow any remaining water to escape.

15. Stand your iron vertically on the charging base and let the iron heat for two minutes to ensure that the iron is dried out completely.
16. After use, switch off and unplug your iron from the mains supply and allow it to fully cool before storing.

Cleaning the steam holes

To remove any build-up in or around the steam holes which may affect steam performance, use a cotton wool tip moistened with methylated spirits. Wipe off the methylated spirits with a damp cloth then dry the soleplate.

Cleaning the exterior of your iron

To clean the exterior of your iron and charging base, wipe it with a soft damp cloth and wipe dry.

Storing

Warning: Allow your iron to completely cool before storing. Always store your iron on its heel rest. Do not store your iron resting on its soleplate.

The SAFE-STORE™ heat indicator shows you when the soleplate of your iron has cooled sufficiently for it to be safe to store. If the strip is red, your iron is too hot. When the words SAFE-STORE appear on the strip against a solid black background, the soleplate is at a safe temperature for storing.

Never wrap the power cord around the soleplate. The cord can be neatly wrapped around the heel of your iron.

After sales service and replacement parts

In the case the appliance does not operate but is under warranty, return the product to the place it was purchased for a replacement. Please be aware that a valid form of proof of purchase will be required. For additional support, please contact our Consumer Service Department at 0800 028 7154 or email: BrevilleEurope@newellco.com.

Troubleshooting

For troubleshooting and FAQs visit www.breville.co.uk/faqs.

PROBLEM	CAUSE	SOLUTION
Iron is not heating.	The appliance is not plugged in, docked onto the charging base, or not switched on.	Check that unit is plugged into the charging base and that the electrical cord is plugged into a working electrical outlet.
	The appliance is in auto-off mode.	Verify the auto-off function is not active. Refer to the 'Auto shut off feature' section.
Iron will not steam.	Insufficient water in the tank.	Ensure water tank level is at least ¼ full.
	The steam control is in the no steam position ☒.	Adjust the steam control to the correct setting for your garment.
	The iron has not been primed before first use.	Press shot of steam button several times to prime.
Steam rate decreases.	Calc build up.	Use self-cleaning feature once a month. Refer to the 'Self-cleaning' section.
Iron is leaking.	The water tank has been filled above the MAX level.	Only fill with water to the MAX level.
	Shot of steam button has been pressed too frequently.	Only use the shot of steam in 3-second intervals or less.
	The water tank is not fully in place, or the fill inlet cover is not closed properly.	Ensure that the fill inlet cover is closed and that the water tank snaps when put into place.
	Water has been left in the water tank during storage.	Empty the water reservoir after each use and move steam control to the no steam position setting.
The steam leaves stains on the fabric or the appliance spits.	You are using water with additives.	Never add any additive in the water tank.
	The appliance has not been cleaned enough after the descaling operation.	Use self-cleaning feature once a month. Refer to the 'Self-cleaning' section.
	Water has been left in the water tank during storage.	Empty water tank completely after each use.
	You are using liquids other than water to descale the product.	Use only water during descaling operation. We recommend using distilled water.
	Impurities are in the water used to fill the iron.	Ensure water cup used to fill the iron is clean.
Wrinkles are not sufficiently removed.	Temperature selected is too low for the fabric being iron.	Check that the temperature control dial is set to the correct fabric setting.
	Ironing thicker fabrics like cotton/linen.	Use shot of steam or spray mist features to help remove stubborn wrinkles.
Fabrics are getting an unwanted shine.	Fabric has been ironed at too high a temperature.	Reduce the temperature setting. Use an ironing cloth or a 100% white cotton fabric and place it between the garment being ironed and the iron to prevent shine.

Electrical safety

⚠ This appliance must be earthed.

If the plug is not suitable for the socket outlets in your home, it can be removed and replaced by a plug of the correct type. If the fuse in a moulded plug needs to be changed, the fuse cover must be refitted. The appliance must not be used without the fuse cover fitted.

If the plug fuse requires replacement, a fuse of the same rating as that fitted by the manufacturer must be used. In order to prevent a hazard do not fit a fuse of a lower or higher rating.

If the terminals in the plug are not marked or if you are unsure about the installation of the plug please contact a qualified electrician.

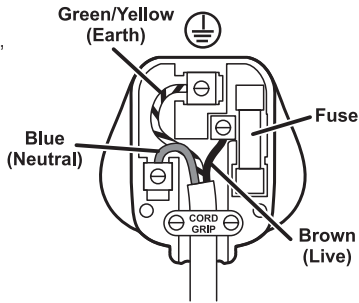

Waste disposal

Waste electrical products should not be disposed of with household waste. Please recycle where facilities exist. E-mail us at BrevilleEurope@newellco.com for further recycling and WEEE information.





Newell Brands (UK) Limited
5400 Lakeside, Cheadle Royal Business Park,
Cheadle, SK8 3GQ, United Kingdom

Newell Poland Services Sp. z o.o.,
Plac Andersa 7, Poznan, 61-894, Poland.

e-mail: BrevilleEurope@newellco.com

Telephone: 0800 028 7154



© 2022 Newell Brands (UK) Limited. All rights reserved.

Newell Brands (UK) Limited, 5400 Lakeside, Cheadle Royal Business Park, Cheadle, Cheshire,
SK8 3GQ, United Kingdom.

Newell Poland Services Sp. z o.o., Plac Andersa 7, Poznan, 61-894, Poland.

Newell Brands (UK) Limited and Newell Poland Services Sp. z o.o. are subsidiaries of Newell
Brands Inc.

The product you buy may differ slightly from the one shown on this carton due to continuing
product development.

Made in China.

VIN439_22EM1 (UK)_GCDS-SL
P.N. NWL0001421130